

CITY OF BRUSH, COLORADO

SNOW REMOVAL MAP

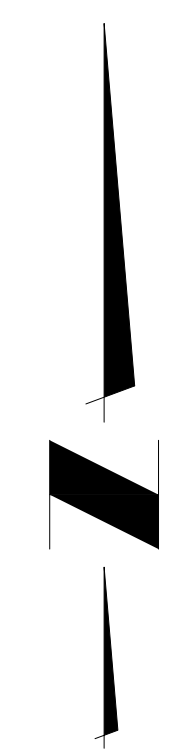

SCALE: 1" = 500'

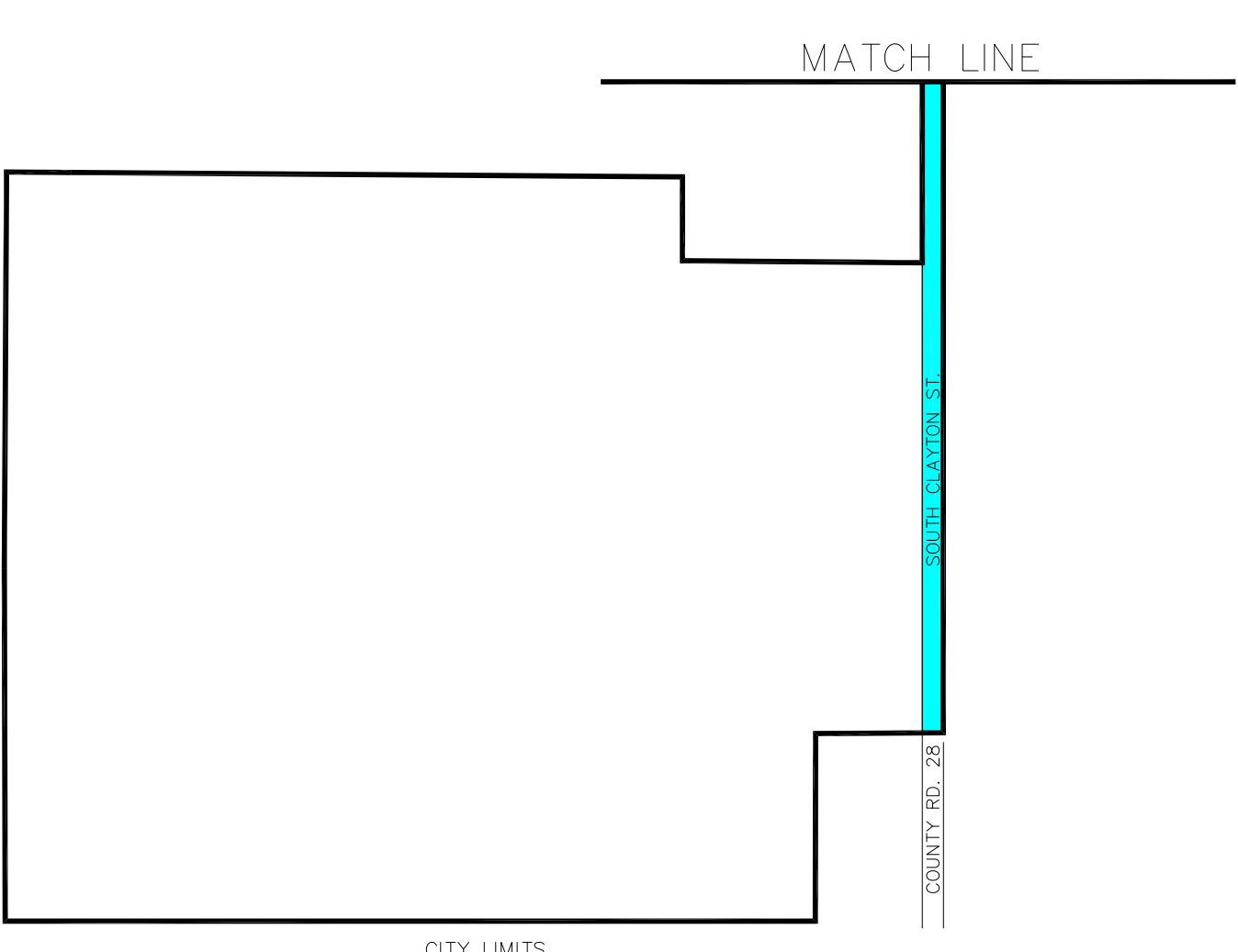
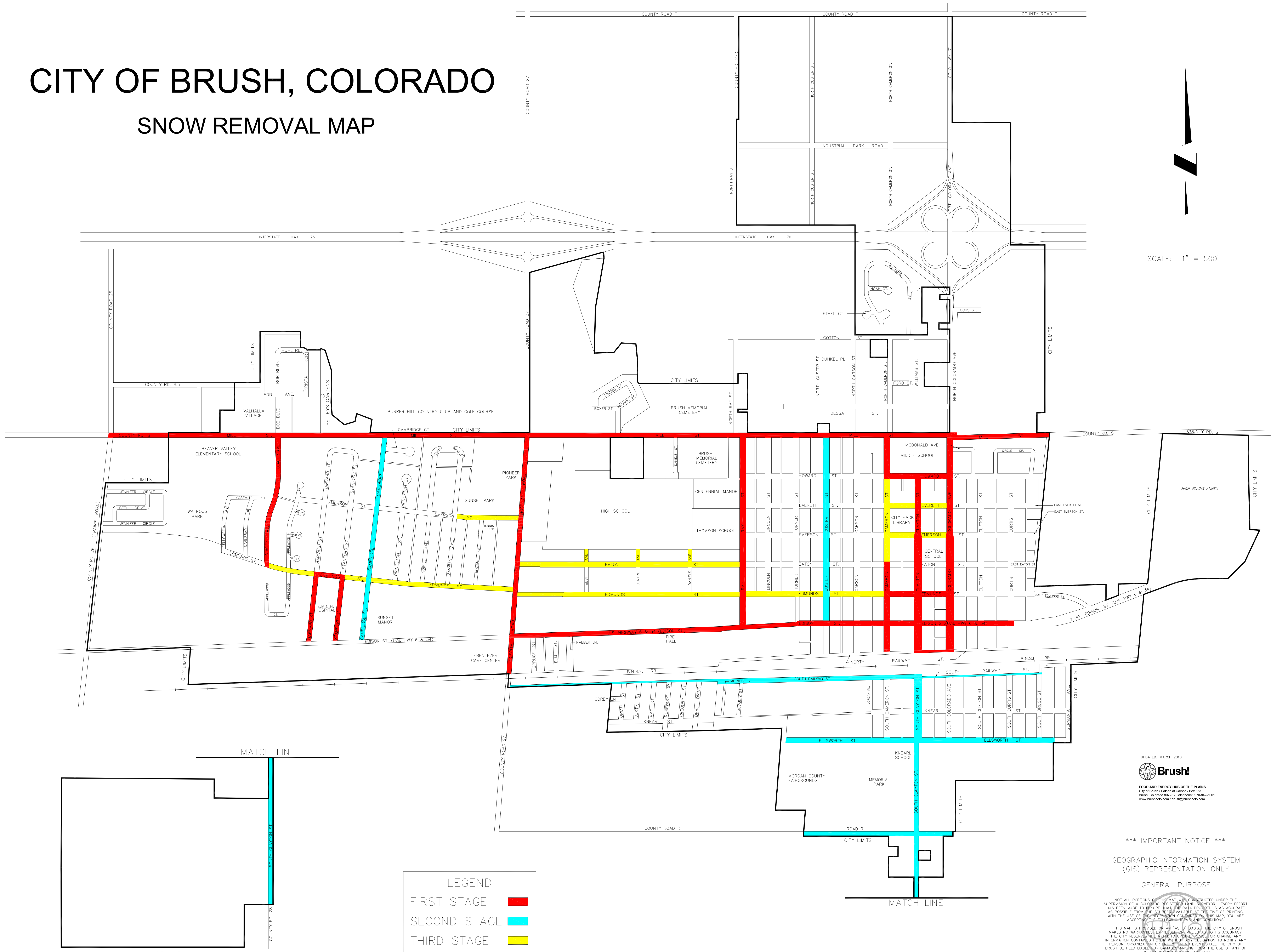

| LEGEND | |
|--------------|---------------------------------------|
| FIRST STAGE | █ |
| SECOND STAGE | █ |
| THIRD STAGE | █ |

UPDATED: MARCH 2010

Brush!
 FOOD AND ENERGY HUB OF THE PLAINS
 City of Brush / Edison at Canon / Box 383
 Brush, Colorado 80723 Telephone: 970.682.0011
 www.brushco.com / brush@brushco.com

*** IMPORTANT NOTICE ***
 GEOGRAPHIC INFORMATION SYSTEM
 (GIS) REPRESENTATION ONLY
 GENERAL PURPOSE

NOT ALL PORTIONS OF THIS MAP WERE CONSTRUCTED UNDER THE SUPERVISION OF A COLORADO REGISTERED LAND SURVEYOR. EVERY EFFORT HAS BEEN MADE TO ENSURE THAT THE DATA PROVIDED IS AS ACCURATE AS POSSIBLE FROM THE SOURCE'S AVAILABLE DATA AT THE TIME OF PRINTING. WITH THE USE OF INFORMATION CONTAINED ON THIS MAP, YOU ARE ACCEPTING THE FOLLOWING TERMS AND CONDITIONS:

THIS MAP IS PROVIDED ON AN "AS IS" BASIS. THE CITY OF BRUSH MAKES NO WARRANTIES, EXPRESSED OR IMPLIED AS TO ITS ACCURACY. THE CITY RESERVES THE RIGHT TO UPDATE, REVISE OR CHANGE ANY INFORMATION CONTAINED HEREIN WITHOUT ANY OBLIGATION TO NOTIFY ANY PERSON, ORGANIZATION OR ENTITY. WE WILL NOT BE RESPONSIBLE FOR THE CITY OF BRUSH BEING HELD LIABLE FOR DAMAGES ARISING FROM THE USE OF ANY OF THE INFORMATION CONTAINED HEREIN.